

**Toot-Toot
Animals**

Doggie Playhouse



VTech understands that a child's needs and abilities change as they grow and with that in mind we develop our toys to teach and entertain at just the right level...

Pre-School

Interactive toys to develop their imagination and encourage language development

vtech Baby

Toys that will stimulate their interest in different textures, sounds and colours

I am...

...responding to colours, sounds and textures

...understanding cause and effect

...learning to touch, reach, grasp, sit-up, crawl and toddle

I want...

...to get ready for school by starting to learn the alphabet and counting

...my learning to be as fun, easy and exciting as can be

...to show my creativity with drawing and music so my whole brain develops

Electronic Learning Computers

Cool, aspirational and inspiring computers for curriculum related learning

I need...

...challenging activities that can keep pace with my growing mind

...intelligent technology that adapts to my level of learning

...National Curriculum based content to support what I'm learning at school

4-10 years

3-6 years

Birth-36 months



To learn more about this and other VTech® products, visit www.vtech.co.uk

INTRODUCTION

Thank you for purchasing the **VTech® Toot-Toot Animals Doggie Playhouse** play set!

Have a howling good time with the **Toot-Toot Animals Doggie Playhouse**. Learn about animals and more with the **SmartPoint™** dog. Explore the dog house, ride on the swing and search for buried treasure!

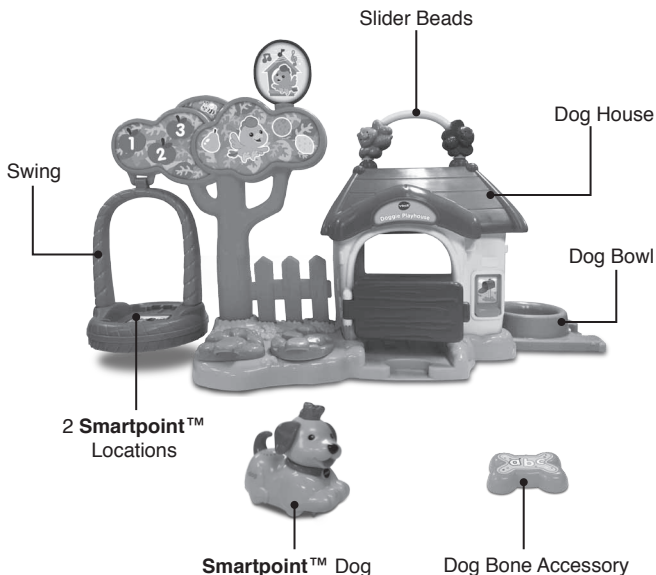

INCLUDED IN THIS PACKAGE



One **SmartPoint™**
Dog



One tree with fence



One **SmartPoint™**
swing base



One swing bracket



One **SmartPoint™**
base



One front wall



One back wall



One roof



One slider with beads



One dog bone
accessory

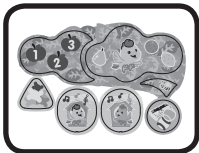

Two label sheets

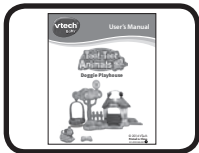

One user's manual

WARNING: All packing materials, such as tape, plastic sheets, packaging locks and tags are not part of this toy, and should be discarded for your child's safety.

NOTE: Please keep this user's manual as it contains important information.

Unlock the packaging locks:

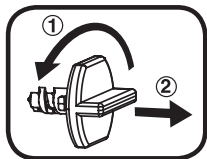

① Turn the packaging lock counter-clockwise several times.

② Pull out and discard the packaging lock.

GETTING STARTED

BATTERY INSTALLATION – DOG

1. Make sure the unit is turned **OFF**.
2. Locate the battery cover on the bottom of the dog. Use a coin or a screwdriver to loosen the screw.
3. Install 2 new AAA (AM-4/LR03) batteries following the diagram inside the battery box. (The use of new alkaline batteries is recommended for maximum performance.)
4. Replace the battery cover and tighten the screw to secure.

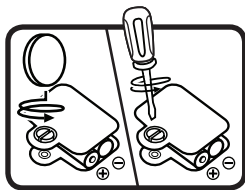

BATTERY NOTICE

- Use new alkaline batteries or fully charged NI-MH (Nickel Metal-hydride) rechargeable batteries for best performance.
- Use only batteries of the same or equivalent type as recommended.
- Do not mix different types of batteries: alkaline, standard (carbon-zinc) or rechargeable (Ni-Cd, Ni-MH), or new and used batteries.
- Do not use damaged batteries.
- Insert batteries with the correct polarity.
- Do not short-circuit the battery terminals.
- Remove exhausted batteries from the toy.
- Remove batteries during long periods of non-use.
- Do not dispose of batteries in fire.
- Do not charge non-rechargeable batteries.
- Remove rechargeable batteries from the toy before charging (if removable).
- Rechargeable batteries are only to be charged under adult supervision.

Disposal of batteries and product



The crossed-out wheeled bin symbols on products and batteries, or on their respective packaging, indicates they must not be disposed of in domestic waste as they contain substances that can be damaging to the environment and human health.



The chemical symbols Hg, Cd or Pb, where marked, indicate that the battery contains more than the specified value of mercury (Hg), cadmium (Cd) or lead (Pb) set out in Battery Directive (2006/66/EC).

The solid bar indicates that the product was placed on the market after 13th August, 2005.

Help protect the environment by disposing of your product or batteries responsibly.

For more information, please visit:

www.recycle-more.co.uk

www.recyclenow.com

Please stick the labels to the play set securely as indicated below:

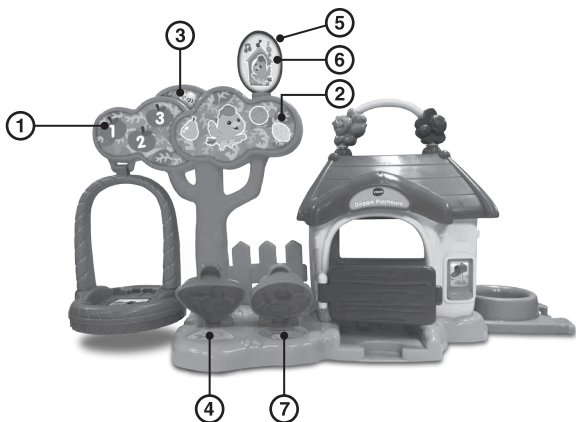
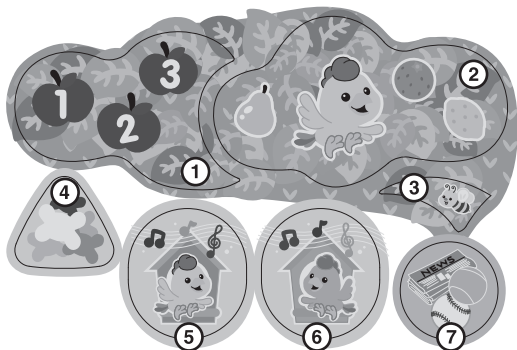

ASSEMBLY INSTRUCTIONS

With the **VTech® Toot-Toot Animals Doggie Playhouse**, safety comes first. To ensure your child's safety, adult assembly is required.

1. Attach the **FRONT WALL** to the **SmartPoint™ BASE**. Then, attach the **BACK WALL** to the **SmartPoint™ BASE** as shown. You will hear a “click” sound to indicate each wall is secured to the **SmartPoint™ BASE**. Once the walls are connected, they cannot be detached.

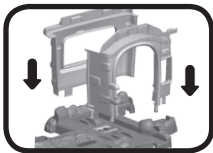

2. Attach the **ROOF** to the top of the dog house as shown. You will hear a “click” sound to indicate the **ROOF** is secure. Once the **ROOF** is connected, it cannot be detached.

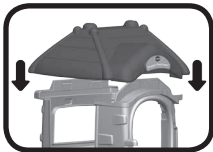

3. Insert the **SLIDER WITH BEADS** into the **ROOF**. You will hear a “click” sound to indicate the **SLIDER WITH BEADS** is secure. Once the **SLIDER WITH BEADS** is connected to the **ROOF**, it cannot be detached.

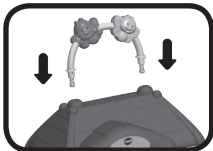

4. Insert the **TREE WITH FENCE** into the **SmartPoint™ BASE** as shown. Once the **TREE WITH FENCE** is connected to the **SmartPoint™ BASE**, it cannot be detached.



5. Insert the **SWING BRACKET** into the **SmartPoint™ SWING BASE**. You will hear a “click” sound to indicate the **SWING BRACKET** and **SmartPoint™ SWING BASE** are secure. Once the **SWING BRACKET** and **SmartPoint™ SWING BASE** are connected, they cannot be detached.

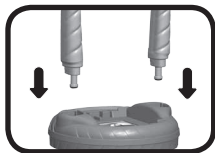

6. Attach the **SWING BRACKET** to the **TREE WITH FENCE** as shown. You will hear a “click” sound to indicate the swing is secure.

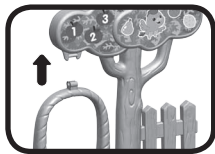

Once you've completed the above steps, you are ready to play! You can connect these pieces to the other included track pieces or you can connect this play set to other **Toot-Toot Animals** play sets (each sold separately).

EXPAND & EXPLORE

Connect to the **Toot-Toot Animals Deluxe Track Set** or other **Toot-Toot Animals** play sets (each sold separately) to expand the **Doggie Playhouse** and inspire creativity.

PRODUCT FEATURES – DOG

1. ON/OFF SWITCH

To turn the unit **ON**, slide the **ON/OFF SWITCH** to the **ON** (⏻) position. To turn the unit **OFF**, slide the **ON/OFF SWITCH** to the **OFF** (●) position.

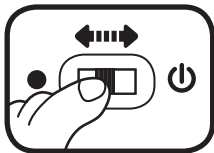

2. AUTOMATIC SHUT-OFF

To preserve battery life, the **VTech® Toot-Toot Animals** dog will automatically power-down after approximately 60 seconds without input. The unit can be turned on again by pressing the light-up button or pushing the dog quickly.

Note: This product is in try-me mode in the packaging. After opening the package, turn the dog off and on again to proceed with normal play.

ACTIVITIES – DOG

1. Slide the **ON/OFF SWITCH** to the **ON** (⏻) position to turn the unit **ON**. You will hear a dog sound, a song and a phrase. The light will flash with the sounds.

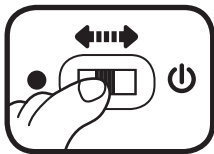

2. Press the **LIGHT-UP BUTTON** to hear fun sounds, sing-along songs and phrases. The light will flash with the sounds.



3. Push the dog to hear fun sounds and melodies. While a melody is playing, push the dog again to add fun sounds over the melody. The light will flash with the sounds.
4. For added fun, the dog interacts with **VTech® Toot-Toot Animals** play sets (each sold separately). Put the dog on one of the play set's **SmartPoint™** locations to hear fun sounds, short tunes and sing-along songs and to see the light flash. You can also play with the dog on other **Toot-Toot Animals** play sets (each sold separately).



ACTIVITIES – DOGGIE PLAYHOUSE

1. Move the dog or any **VTech® Toot-Toot Animals SmartPoint™** animal (each sold separately) over one of the two **SmartPoint™** locations to trigger fun phrases, sounds and music.
2. Place the dog on the swing to trigger a fun response, and to pretend to play on the tyre swing.



3. Open and close the doggie door to let the dog in and out of the house. When the dog is placed in the house, the **SmartPoint™** will trigger a fun response.



4. Pull the dog bowl on the side of the house down when the dog is ready to eat. Push it back up when he is finished.



5. Lift the bushes and rock pile up and down to find what the dog has hidden around his house.



6. Move the sliding beads back and forth to pretend the butterfly and bee are flying around the house.

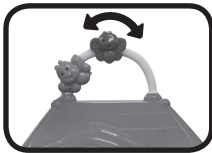

CARE & MAINTENANCE

1. Keep the unit clean by wiping it with a slightly damp cloth.
2. Keep the unit out of direct sunlight and away from any direct heat source.
3. Remove the batteries when the unit will not be in use for an extended period of time.
4. Do not drop the unit on hard surfaces and do not expose the unit to moisture or water.

TROUBLESHOOTING

If for some reason the program/activity stops working or malfunctions, please follow these steps:

1. Turn the unit **OFF**.
2. Interrupt the power supply by removing the batteries.
3. Let the unit stand for a few minutes, then replace the batteries.
4. Turn the unit back **ON**. The unit will now be ready to play again.
5. If the unit still does not work, replace with an entire set of new batteries.

If the problem persists, please call our Consumer Services Department on 01235 546810 (from UK) or +44 1235 546810 (outside UK) and a service representative will be happy to help you.

TECHNICAL SUPPORT

If you have a problem that cannot be solved by using this manual, we encourage you to visit us online or contact our Consumer Services Department with any problems and/or suggestions that you might have. A support representative will be happy to assist you.

Before requesting support, please be ready to provide or include the information below:

- The name of your product or model number (the model number is typically located on the back or bottom of your product).
- The actual problem you are experiencing.
- The actions you took right before the problem started.

Internet: www.vtech.co.uk

Phone: 01235 546810 (from UK), or +44 1235 546810 (outside UK)

IMPORTANT NOTE:

Creating and developing **VTech®** products is accompanied by a responsibility that we take very seriously. We make every effort to ensure the accuracy of the information, which forms the value of our products. However, errors sometimes can occur. It is important for you to know that we stand behind our products and encourage you to call our Consumer Services Department on 01235 546810 (from UK), or +44 1235 546810 (outside UK), with any problems and/or suggestions that you might have. A service representative will be happy to help you.



**CLASS 1
LED PRODUCT**



PRODUCT WARRANTY



Thank you for choosing this quality product from VTech. We hope it will bring many hours of entertainment, imaginative play and learning.

1. The product detailed above is covered by a one year warranty from the date of purchase, against any defects in materials or workmanship.
2. The product may be returned to the place of purchase. Alternatively the product can be returned to VTech Electronics Europe plc (see address below), with proof of purchase, without proof of purchase no replacement will be provided.
3. VTech Electronics Europe plc will examine the product and if it is found to be defective due to faulty materials or workmanship, will replace the product at their discretion.
4. If the product covered by this warranty is damaged due to misuse, modification or unauthorised repair, or because of faulty batteries, battery discharge or incorrect electrical connections, then this warranty becomes void.
5. This warranty is personal to the original purchaser and is not transferable.
6. Breakages to the LCD screen are not covered by the warranty.
7. Returns to VTech Electronics Europe plc should include a cheque or postal order for £1.50 towards the cost of return postage and packaging.
8. Products returned to VTech Electronics Europe plc, should be addressed as follows and packed carefully to avoid damage in transit (Please do not include batteries or adaptor). Please include details of the fault together with your name and address.
9. To keep an online record of your warranty, please register your product online at www.vtech.co.uk/warranty

VTech Electronics Europe plc, c/o Tablogix Limited, 200 Milton Park, Abingdon, Oxon OX14 4TA

THIS WARRANTY IS OFFERED AS AN EXTRA BENEFIT AND DOES NOT AFFECT CONSUMERS' STATUTORY RIGHTS.

This warranty is valid for the UK and Eire only. For products purchased outside the UK and Eire, please contact your local distributor or place of purchase.

